

:: FLOOR PLAN  
(Not Actual Location)



**LJ Hooker**  
Property Hub

Roberto Scartozzi 0406 421 679  
Lisa Psaras 0477 979 794

10 Carl Lentz Court  
**WORONGARY**

4,097m<sup>2</sup> or 1.1 Acres

5 Bed + Media + Office

2 Bath + Powder

9+ Car + Off-Street

Internal 420m<sup>2</sup> | Covered Externals 89m<sup>2</sup> | **Total 509m<sup>2</sup>**

Workshed (not shown) 119m<sup>2</sup>

DISCLAIMER: This is not a legal document therefore all measurements and information provided is subject to survey. No permission is given to use or alter this Floor Plan without the consent of Pure Design Concepts. The overall presentation style, layout, imagery, fonts, background, colours and terminology has been originally created by PDC and is subject to strict copyright. No ownership is taken of building design. Find out more at [puredesignconcepts.com.au](http://puredesignconcepts.com.au)

pdc.

### SITE PLAN LEGEND

- 1. Secure Electric Gate | 2. Entry Path
- 3. Large Vehicle Parking | 4. Covered Patios
- 5. Entry Porch | 6. PV Solar Panels
- 7. Garden Courtyard
- 8. Covered Outdoor Entertaining
- 9. Lawn | 10. Swimming Pool

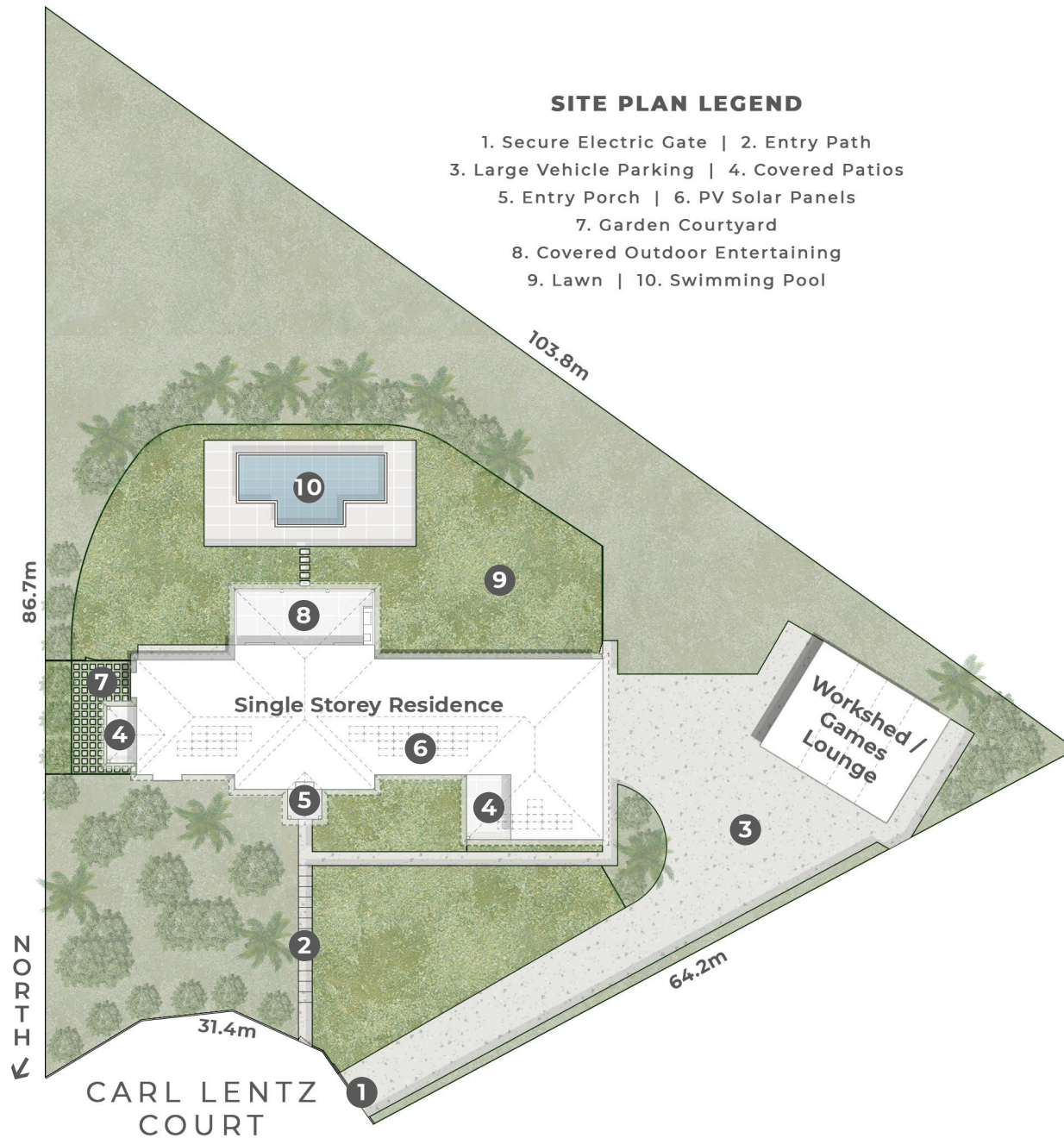

**LJ Hooker**  
Property Hub

Roberto Scartozzi 0406 421 679  
Lisa Psaras 0477 979 794

10 Carl Lentz Court  
**WORONGARY**

 4,097m<sup>2</sup> or 1.1 Acres

 5 Bed + Media + Office

 2 Bath + Powder

 9+ Car + Off-Street

Internal 420m<sup>2</sup> | Covered Externals 89m<sup>2</sup> | **Total 509m<sup>2</sup>**

Workshed 119m<sup>2</sup>

DISCLAIMER: This is not a legal document therefore all measurements and information provided is subject to survey. No permission is given to use or alter this Floor Plan without the consent of Pure Design Concepts. The overall presentation style, layout, imagery, fonts, background, colours and terminology has been originally created by PDC and is subject to strict copyright. No ownership is taken of building design. Find out more at [puredesignconcepts.com.au](http://puredesignconcepts.com.au)

**pdc.**